

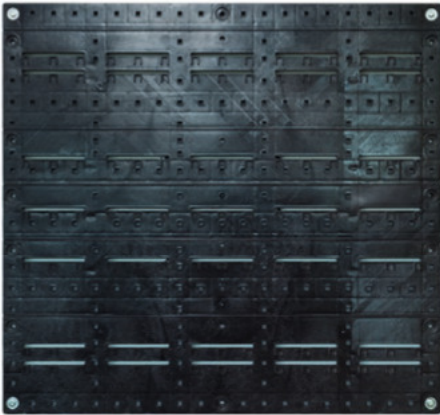

**INSTALLING THE NEXT GENERATION LIVING WALLS**

**STANDARD COMPONENTS**



**Grid**



**Tray with Drains**



**Leaf Screen**



**Bottom Tray (No Drains)**



**Drain Hose**



Side Panels



HydroScreens



Water Meter



Track Lighting

## OPTIONAL COMPONENTS

## Tools Required





STEP 1: INSTALL THE GRIDS



## STEP 2: ATTACH THE TRAYS

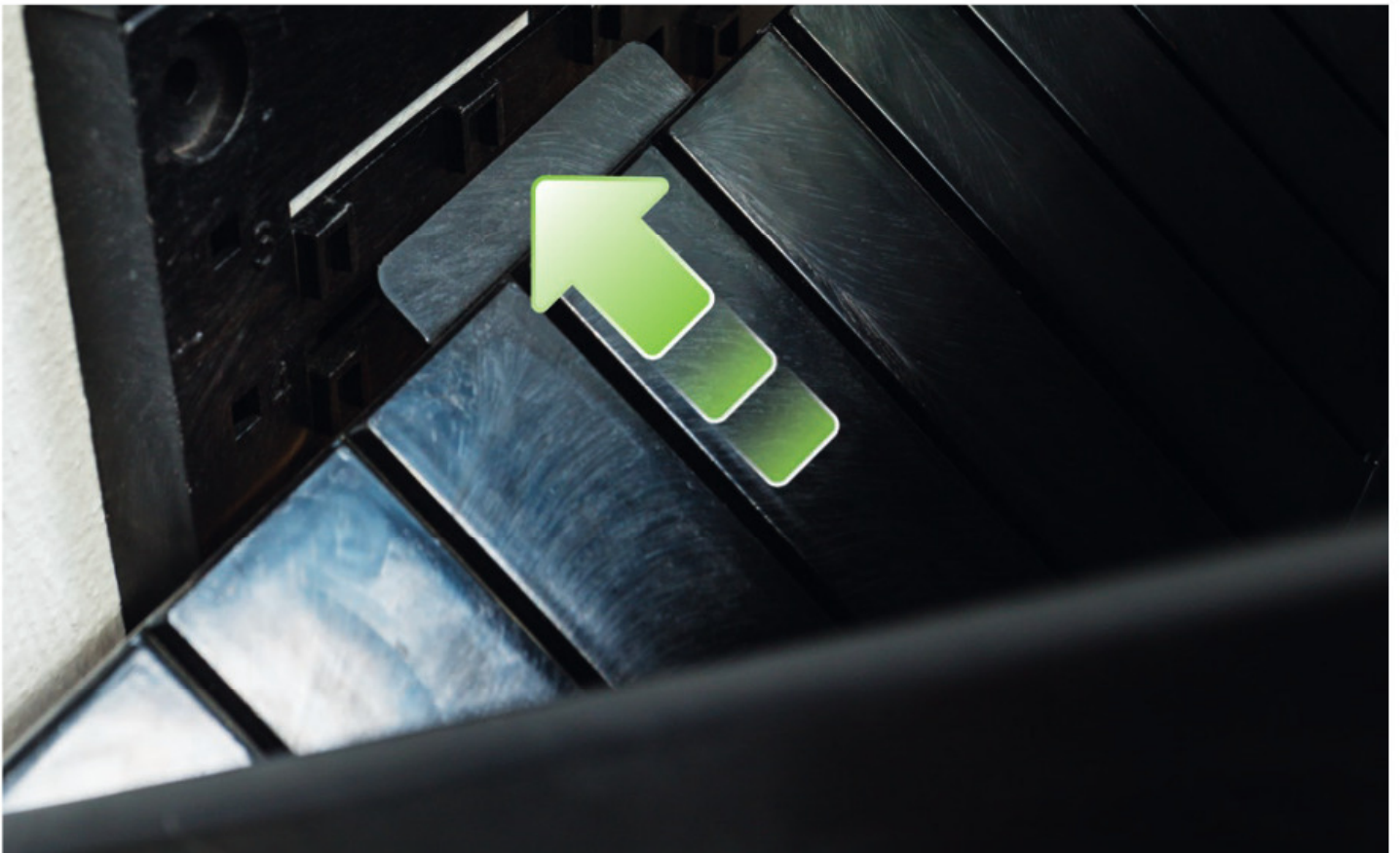

STEP 3: ATTACH THE SIDE PANELS





STEP 4: PLANT THE WALL









## PLANT VARIETIES ·

When proper Lighting is present, virtually any kind of plant can thrive in the NextGen Living Walls. On this page we show several varieties that provide good coverage and do well on a 4-week watering cycle.

## A few of the many plant types that will work well on your wall...

### PLANT VARIETIES ·

When proper Lighting is present, virtually any kind of plant can thrive in the NextGen Living Walls. On this page we show several varieties that provide good coverage and do well on a 4-week watering cycle.

#### Upright Plants ·



Aglaonema Premium



Dracaena Dragon



Syngonium Pink

#### Hanging Plants ·



Philo Brazil



Golden Pothos



Chlorophytum Spider Plant

TRAY

PLANT SIZE THAT FITS TRAY

Europe

North America

PT-50-1210

12 cm D x 10 cm H  
Soil Plants



4" Soil Plants



PT-100-1312

13 cm D x 12 cm H  
Hydro Plants



6" Soil Plants



14 cm D x 14 cm H  
Soil Plants



PT-100-1519

15 cm D x 19 cm H  
Hydro Plants



Soil Plants up to 8" D.



Soil Plants up to 20 cm D



Hybrid Combination  
in 15 cm D x 19 cm H



Soil

Hydro

Hybrid Combination  
in 15 cm D x 19 cm H



Soil

Hydro



[www.PlanterDesigns.com](http://www.PlanterDesigns.com)

planterdesigns



## Watering

NextGen is engineered for water to flow from top to bottom. We recommend the Nature's Green Water Machine for maximum efficiency.

**Ask your PlanterDesigns Rep for your special price...**



[www.PlanterDesigns.com](http://www.PlanterDesigns.com)

[sales@PlanterDesigns.com](mailto:sales@PlanterDesigns.com)

*planterdesigns*



## Automatic Watering •

Automatic watering systems work well with NextGen. We can direct you to our partners who specialize in this.



### Optional Lighting System •

We offer special LED Track Lighting that is CE and RoHS approved and has a UL approved LED driver.



Please refer to the Specifications on the back page of this brochure for more details.

## Next Gen - Specifications

GRIDS	Description	Length		Height		Depth		Weight	
		CM	IN	CM	IN	CM	IN	KG	LBS
GRID-5075	Grid for the PT-50-1210 Trays	50	19.7	75	29.5	2	0.8	1,75	3.9
GRID-8075	Grid for the PT-100-1312 and PT-100-1519 Trays	80	31.5	75	29.5	2	0.8	2,8	6.2

TRAYS	Description	Length		Height		Depth		Weight		# of plants per tray		Water Capacity when unplanted		Estimated Weight when planted/watered	
		CM	IN	CM	IN	CM	IN	KG	LBS	Hydro	Soil	Liters	Gallons	KG	LBS
PT-50-1210	Holds 12 cm x 10 cm H or 4" soil plants.	50	19.7	13	5.1	15	5.9	1	2.2	na	3-4	1,6	0.42	5	11.0
PT-50-1210-DP*															
PT-100-1312	Holds 13 cm x 12 cm Hydro or 14 cm soil or 6" soil plants.	100	39.4	17	6.7	20	7.9	1,8	4.0	6	5	5,4	1.43	12,5	27.6
PT-100-1312-DP*															
PT-100-1519	Holds 15 cm x 19 cm Hydro or 20 cm or 8" soil plants.	100	39.4	17	6.7	26	10.2	2,5	5.5	5	4	7	1.85	15	33.1
PT-100-1519-DP*															

\*DP stands for Drain Post. When no "DP" in model it is a no hole tray and often is used as the bottom tray in a vertical row.

### TRAY AND GRID COMBINATIONS

	Estimated Weight planted/watered		Area Covered	
	KG	LBS	M2	Sq. Ft.
5 PT-50-1210 ON GRID-5075	27	60	0,375	4
4 PT-100-1312 ON GRID-8075	53	117	0,75	8
3 PT-100-1519 ON GRID-8075	48	106	0,75	8

### ACCESSORIES\*\*

LF-09	Leaf Screen
DH-14	Drain Hose for PT-50-1210-DP
DH-24	Drain Hose for PT-100-1519-DP and PT-100-1312-DP
SP-1880	18 cm x 80 cm Side Panels for PT-50-1210 installations.
SP-18155	18 cm x 155 cm Side Panels for PT-50-1210 installations.
SP-2480	24 cm x 80 cm Side Panels for PT-100-1312 installations.
SP-24155	24 cm x 155 cm Side Panels for PT-100-1312 installations.
SP-3080	30 cm x 80 cm Side Panels for PT-100-1519 installations.
SP-30155	30 cm x 155 cm Side Panels for PT-100-1519 installations.
HS-1312	HydroScreen for 1312 hydro pots
HS-1519	HydroScreen for 1519 hydro pots

\*\*We also have fasteners for attaching the Grids to walls and Velcro for attaching the Side Panels to the Walls.

### OPTIONAL WATER MACHINE

WM-95L	95 Liter Water Machine (25 gallon)
FI-WM95L	Fertilizer Infuser for Water Machine

### OPTIONAL LED LIGHTING SPECS

LED40	LED Light 40 watt
Wattage	40w
Color Temperature	5500k
Beam Angle	60 degrees
Number of Wires	3 (2 conductors, 1 ground)
Phase	Single
Coverage	1.5 to 2 square meters (15-20 square feet)
Certifications	CE, RoHS approved, UL approved LED Driver

